



Las Vegas

LAS VEGAS
**CONVENTION
CENTER**

VegasMeansBusiness.com





THIS EXPANSION IS OUR COMMITMENT TO OUR CLIENTS – TO DELIVER THE EXCELLENT SERVICE AND AMENITIES THAT HAVE MADE LAS VEGAS THE WORLD’S PREMIER DESTINATION.

— STEVE HILL, LVCVA/CEO PRESIDENT

IN THIS AGE OF INNOVATION, Las Vegas allows visionaries to come together to share ideas and push their industries even further by providing the world’s top destination for conventions and trade shows.

Beyond the ability to accommodate convention and trade shows of any size with millions of square feet of indoor and outdoor exhibit and meeting space, guests and attendees are met with an unrivaled experience from the moment they arrive.

Las Vegas has hospitality professionals trained to handle your needs. On top of unparalleled entertainment opportunities from award-winning shows, to professional sports, Las Vegas is home to world-class cuisine, one-of-a-kind attractions, excellent shopping and a variety of outdoor activities.

With the space, technology and commitment to excellence, there is no question that Las Vegas is the quintessential convention and trade show locale.

TABLE OF CONTENTS

CONVENTION CENTER OVERVIEW	05
CAMPUS MAP	06
MEETING ROOMS & EXHIBIT HALLS	09
EXHIBIT HALLS	11
MEETING ROOMS C102, C201-C206, N101-120, N201-N212	13
MEETING ROOMS N213 - N251	15
MEETING ROOMS N252-N264, DIAMOND 1-4, S101-S118	17
MEETING ROOMS S201 - S233	19
MEETING ROOMS W101-W110, W201-W218	21
MEETING ROOMS W219 - W243	23
MEETING ROOMS W301-W327, TERRACE	25
FREIGHT AND ROLL-UP DOOR MAPS	26
PARKING LOTS	29
SERVICES & POLICIES	30



WE'VE CONSIDERED ALL YOUR OPTIONS.

The Las Vegas Convention and Visitors Authority presents the Las Vegas Convention Center, a facility designed to maximize your event's convenience, efficiency and impact. The Las Vegas Convention Center can accommodate almost any size meeting or convention.

OUTSTANDING FACILITIES AND MEETING ROOMS

- The new West Hall will provide an additional 600,000 square feet of exhibition space, 150,000 square feet of meeting room space including a 14,000 square-foot outdoor terrace with views of the iconic Strip
- Exhibit halls - all contiguous space
- 2,542,591 square feet of exhibit space for 13,238 10'x10' booths
- 391,536 square feet of meeting space
- 225 meeting rooms
- 225,000-square-foot lobby/registration space
- Two 15,000-square-foot restaurants: Lucky's Restaurant seats 600 and Aces offers a combined total of nearly 1,000 seats
- Full compliance with the American Disabilities Act
- Parking for more than 5,000 cars
- The 11 halls on ground level in the North, Central, South and West halls have a floor-load of 450 lbs. per square foot and the two halls on the second floor in the South halls have 300 lbs. per square foot load capacity

“
THE BORING COMPANY IS EXCITED TO CONTRIBUTE TO
THE FUTURE OF LAS VEGAS, AND WORK WITH LEADERS
WHO HAVE A VISION FOR TRANSPORTATION.

- STEVE DAVIS, TBC PRESIDENT

THE BORING COMPANY UNDERGROUND TRANSPORTATION SYSTEM

The first commercial endeavour for The Boring Company, the Convention Center Loop will serve as an innovative, fun and quick transportation solution to move thousands of convention attendees throughout the more than 200-acre campus.

LAS VEGAS CONVENTIONS CENTER | CAMPUS

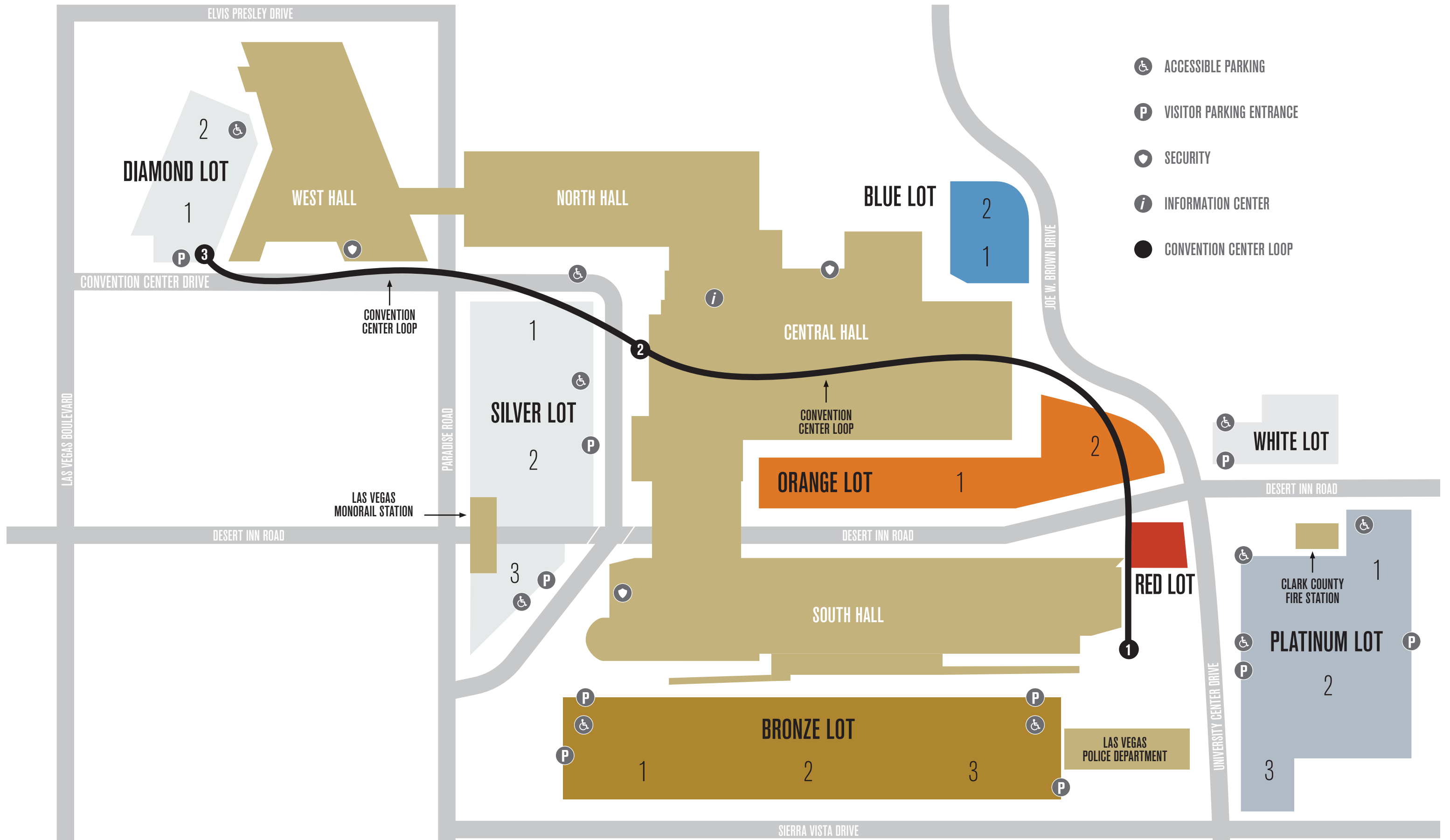

- ACCESSIBLE PARKING
- VISITOR PARKING ENTRANCE
- SECURITY
- INFORMATION CENTER
- CONVENTION CENTER LOOP



SPECIFICATIONS FOR
**MEETING ROOMS
& EXHIBIT HALLS**



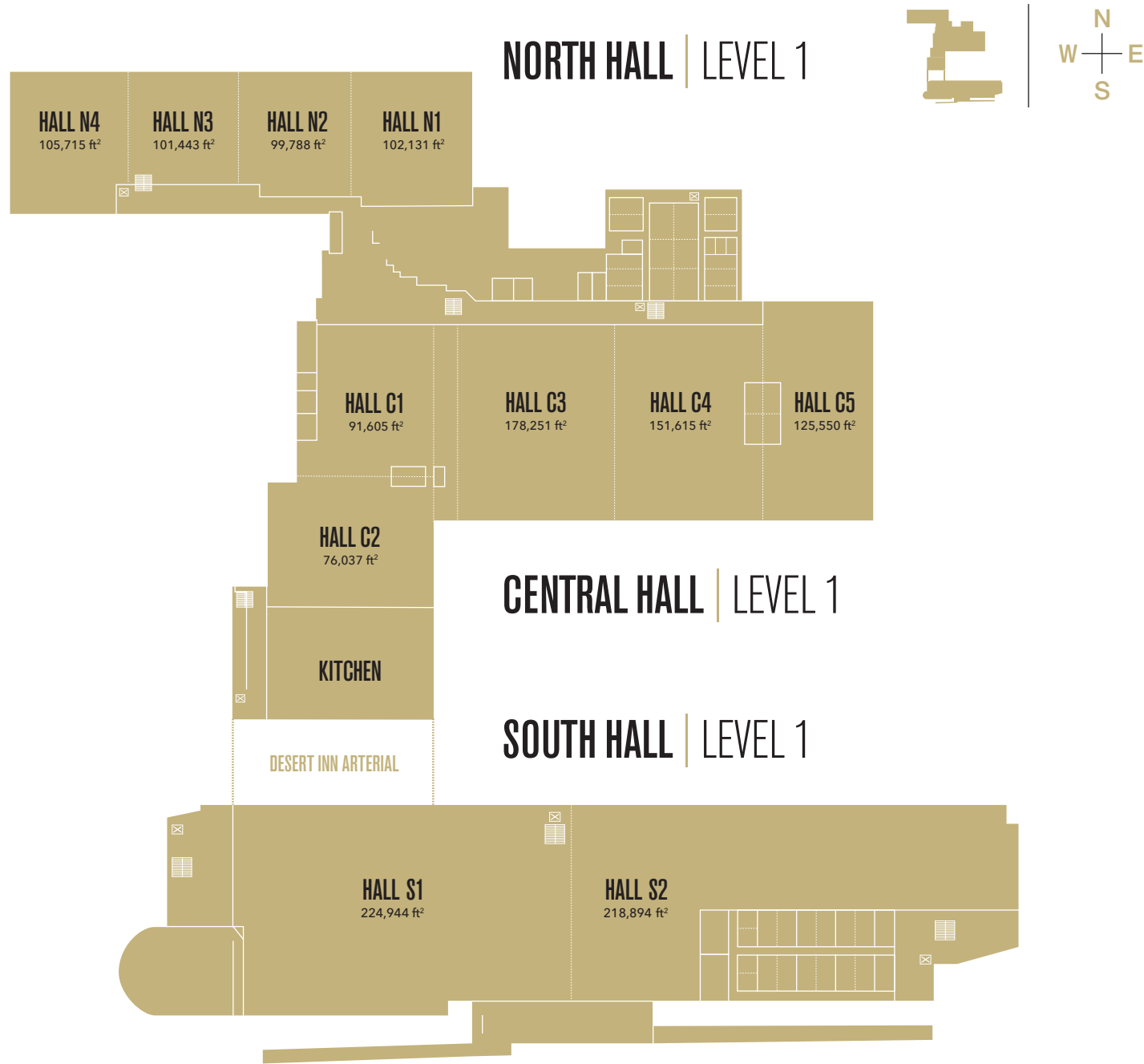

NORTH HALL | LEVEL 1

CENTRAL HALL | LEVEL 1

SOUTH HALL | LEVEL 1

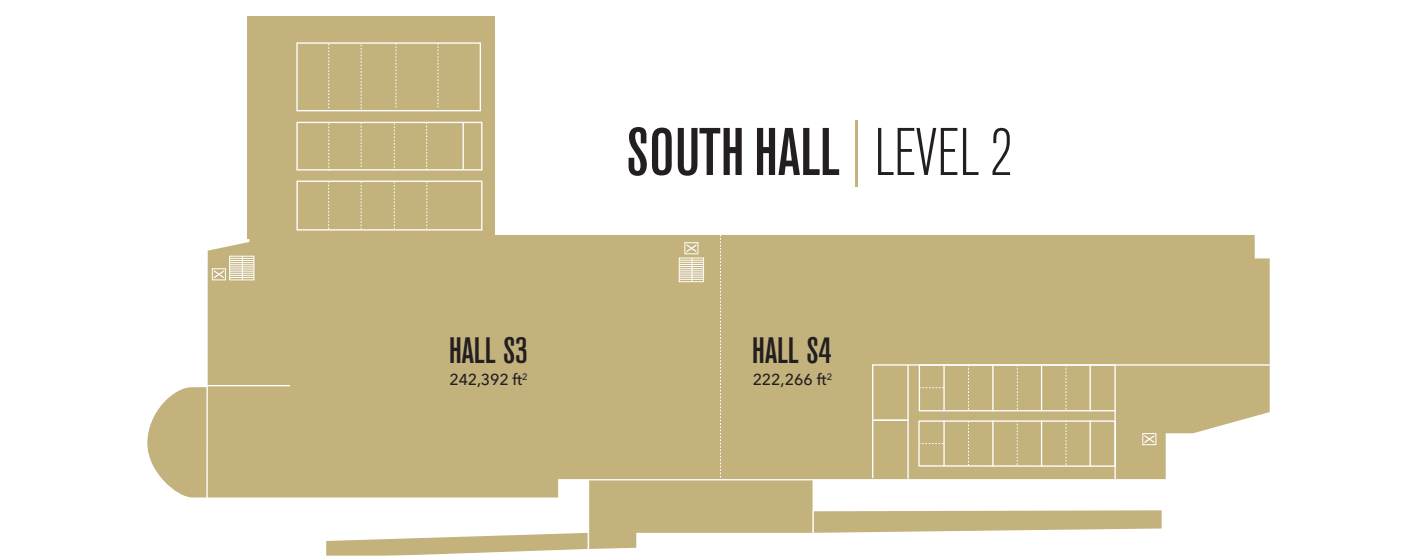

SOUTH HALL | LEVEL 2

EXHIBIT HALL INFORMATION

EXHIBIT HALL	SQUARE FEET	DAILY RATE \$	CEILING HEIGHT	10X10 ROOM CAPACITY
N1	102,131	\$17,850	35'	510
N2	99,788	\$17,450	35'	514
N3	101,443	\$17,750	33'	505
N4	105,715	\$18,500	33'	540
TOTAL N1-N4	409,077	\$71,550		2,069
C1	91,605	\$16,050	25'	501
C2	76,037	\$13,300	25'	427
C3	178,251	\$31,200	31' & 35'	1,006
C4	151,615	\$26,550	35'	852
C5	125,550	\$21,950	35'	667
TOTAL C1-C5	623,058	\$109,050		3,453
S1	224,944	\$35,450	25'	1,082
S2	218,894	\$34,500	30'	1,043
S3	242,392	\$38,200	25'	1,219
S4	222,266	\$35,000	25'	1,078
TOTAL S1-S4	908,496	\$143,150		4,422
W1	140,960	\$ 24,700	42'	765
W2	155,790	\$ 27,250	42'	843
W3	151,010	\$ 26,450	42'	920
W4	154,200	\$ 27,000	42'	806
TOTAL W1-W4	601,960	\$ 105,450		3,334
TOTAL ALL HALLS	2,542,591	\$ 429,200		

WEST HALL | LEVEL 1



Maps are not 100% true to scale, actual layout/size may vary.

CENTRAL & NORTH HALL | LEVEL 1

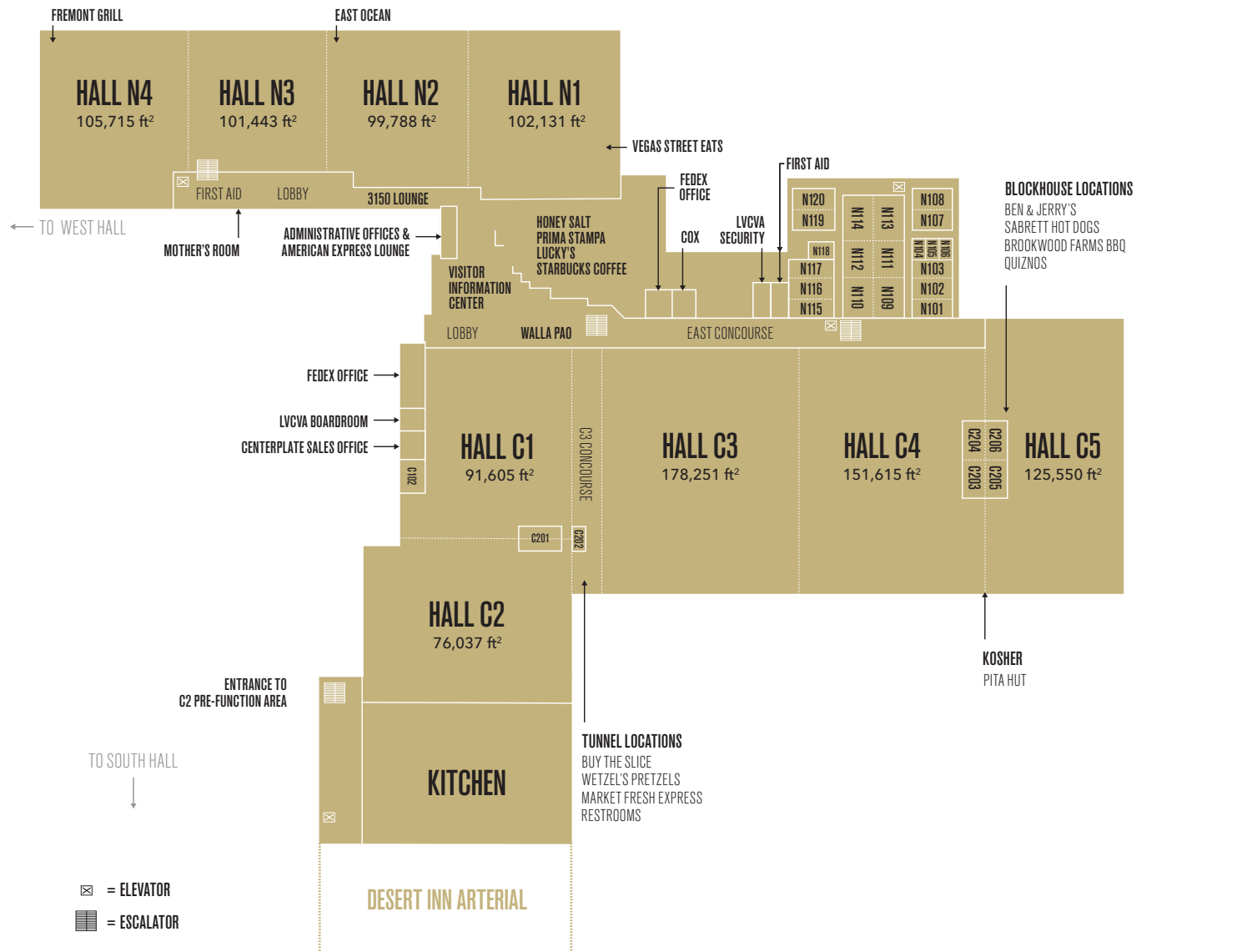

MEETING ROOMS | C102 - N212

MEETING ROOM	ROOM DIMENSION	SQUARE FEET	CEILING HEIGHT	DAILY RATES	THEATER CAPACITY	CLASSROOM CAPACITY	BANQUET CAPACITY
C102	51' x 42'	2,177	10'6"	NA	147	96	120
C201	54' x 30'	1,598	9'8"	NA	125	48	80
C202	28' x 29'	781	7'9"	NA	48	20	30
C203	33' x 26'	870	8'6"	NA	55	32	40
C204	33' x 26'	869	8'6"	NA	55	32	40
C205	28' x 35'	775	8'6"	NA	38	24	40
C206	24' x 36'	835	8'6"	NA	54	32	50
N101	50' x 40'	2,020	12'	\$700	158	80	120
N102	50' x 39'	2,038	12'	\$700	158	80	120
N103	50' x 39'	2,026	12'	\$700	159	80	120
N104	23' x 19'	463	12'	\$150	28	12	20
N105	23' x 20'	479	12'6"	\$150	21	16	20
N106	23' x 20'	475	12'6"	\$150	21	16	20
N107	50' x 40'	2,029	12'6"	\$700	144	72	110
N108	50' x 39'	2,030	12'6"	\$700	144	72	110
N109	59' x 46'	2,809	20'	\$1,000	240	128	180
N110	59' x 46'	2,814	20'	\$1,000	240	128	180
N111	59' x 46'	2,802	20'	\$1,000	240	128	180
N112	59' x 46'	2,805	20'	\$1,000	240	128	180
N113	59' x 46'	2,812	20'	\$1,000	240	128	180
N114	59' x 46'	2,813	20'	\$1,000	240	128	180
N115	50' x 40'	2,032	12'6"	\$700	144	72	110
N116	50' x 39'	2,044	12'6"	\$700	144	72	110
N117	50' x 39'	2,027	12'6"	\$700	144	72	110
N118	31' x 23'	727	12'6"	\$250	44	24	30
N119	50' x 39'	2,025	12'6"	\$700	144	72	110
N120	50' x 39'	2,032	12'6"	\$700	144	72	110
N201	42' x 27'	1,065	12'	\$350	80	40	50
N202	42' x 28'	1,069	12'	\$350	80	40	50
N203	42' x 27'	1,060	12'	\$350	80	40	50
N204	42' x 28'	1,065	12'	\$350	80	40	50
N205	38' x 27'	954	12'	\$350	70	32	50
N206	38' x 27'	954	12'	\$350	70	32	50
N207	38' x 27'	969	12'	\$350	70	32	50
N208	38' x 27'	969	12'	\$350	70	32	50
N209	43' x 28'	1,088	12'	\$400	80	40	60
N210	43' x 27'	1,079	12'	\$400	80	40	60
N211	43' x 28'	1,090	12'	\$400	80	40	60
N212	43' x 27'	1,082	12'	\$400	80	40	60

NORTH HALL | LEVEL 2

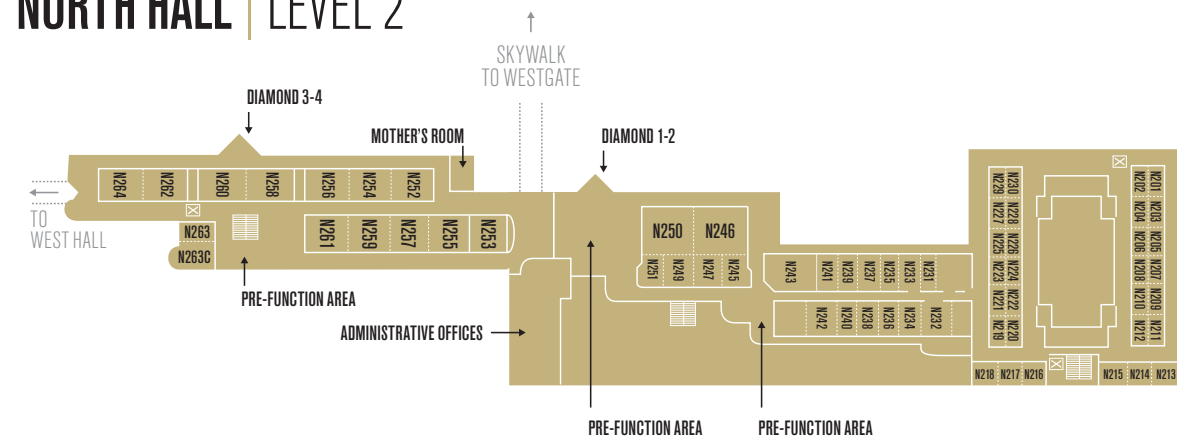

NORTH HALL | LEVEL 2

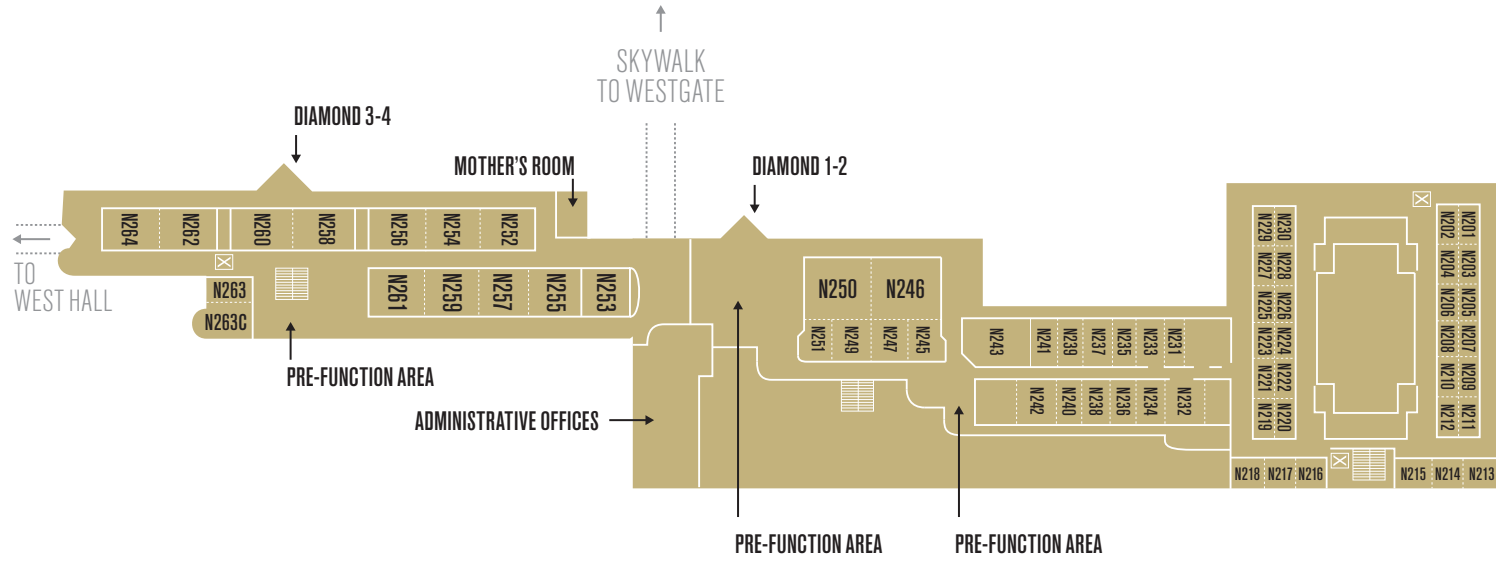

MEETING ROOMS | N213 - N251

MEETING ROOM	ROOM DIMENSION	SQUARE FEET	CEILING HEIGHT	DAILY RATES	THEATER CAPACITY	CLASSROOM CAPACITY	BANQUET CAPACITY
N213	41' x 31'	1,068	12'	\$350	84	36	50
N214	30' x 31'	872	12'	\$300	44	24	40
N215	26' x 28'	755	12'	\$250	44	24	40
N216	26' x 20'	565	12'	\$200	28	16	30
N217	30' x 31'	857	12'	\$300	52	24	50
N218	40' x 31'	1,055	12'	\$350	72	32	50
N219	43' x 27'	1,086	12'	\$400	80	40	50
N220	43' x 27'	1,086	12'	\$400	80	40	50
N221	43' x 27'	1,076	12'	\$400	80	40	50
N222	43' x 27'	1,075	12'	\$400	80	40	50
N223	38' x 27'	956	12'	\$350	70	32	50
N224	38' x 27'	963	12'	\$350	70	32	50
N225	38' x 27'	955	12'	\$350	70	32	50
N226	38' x 27'	964	12'	\$350	70	32	50
N227	42' x 27'	1,061	12'	\$350	80	40	50
N228	42' x 27'	1,052	12'	\$350	80	40	50
N229	42' x 27'	1,067	12'	\$350	80	40	50
N230	42' x 27'	1,059	12'	\$350	80	40	50
N231	47' x 25'	1,155	13'	\$400	84	48	60
N232	45' x 43'	1,879	13'	\$650	160	80	120
N233	47' x 30'	1,379	13'	\$500	111	48	70
N234	43' x 30'	1,217	13'	\$450	91	40	70
N235	47' x 30'	1,379	13'	\$500	111	48	70
N236	43' x 30'	1,212	13'	\$400	85	40	70
N237	47' x 30'	1,381	13'	\$500	111	40	70
N238	43' x 29'	1,206	13'	\$400	85	32	60
N239	47' x 30'	1,379	13'	\$500	111	60	60
N240	43' x 30'	1,219	13'	\$450	78	60	50
N241	47' x 31'	1,380	13'	\$500	106	60	70
N242	43' x 43'	1,829	13'	\$650	139	80	100
N243	50' x 48'	2,298	12'6"	\$800	187	92	120
N245	45' x 37'	1,647	19'	\$600	105	64	80
N246	77' x 67'	5,206	19'	\$1,800	493	284	330
N247	45' x 40'	1,718	19'	\$600	119	80	90
N249	45' x 44'	1,903	19'	\$650	135	80	90
N250	77' x 67'	5,197	19'	\$1,800	493	264	320
N251	45' x 39'	1,640	19'	\$550	92	76	80



NORTH HALL | LEVEL 2

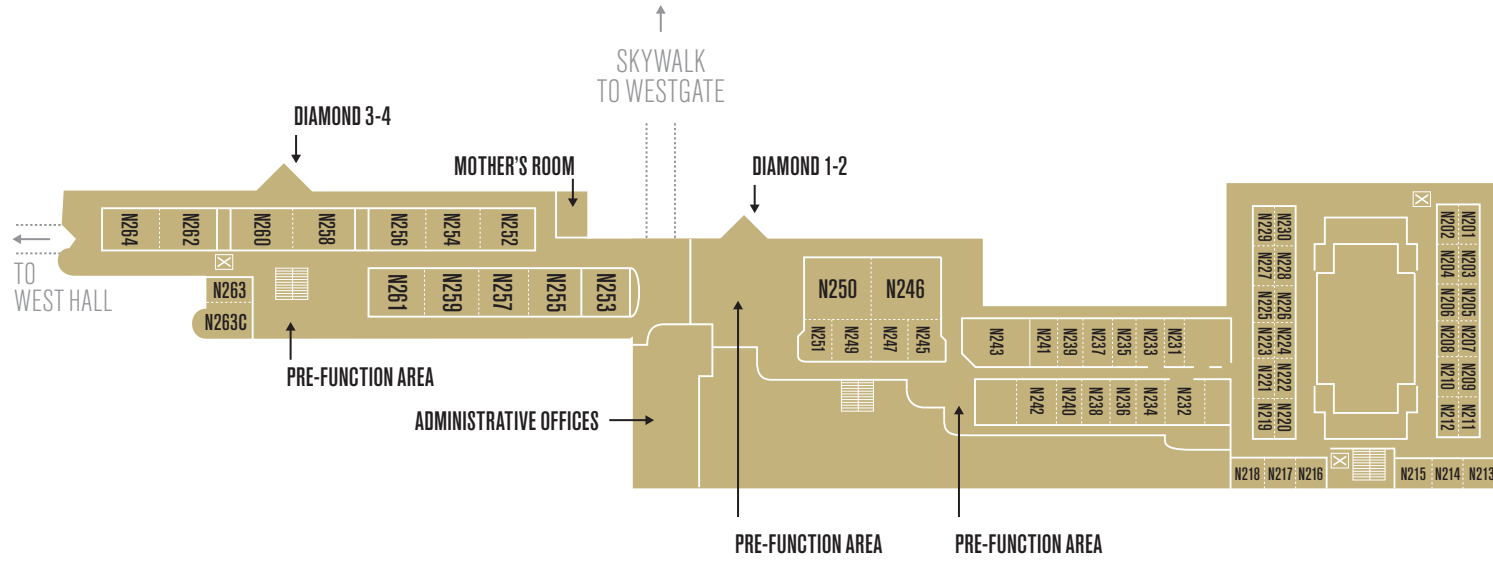

SOUTH HALL | LEVEL 1

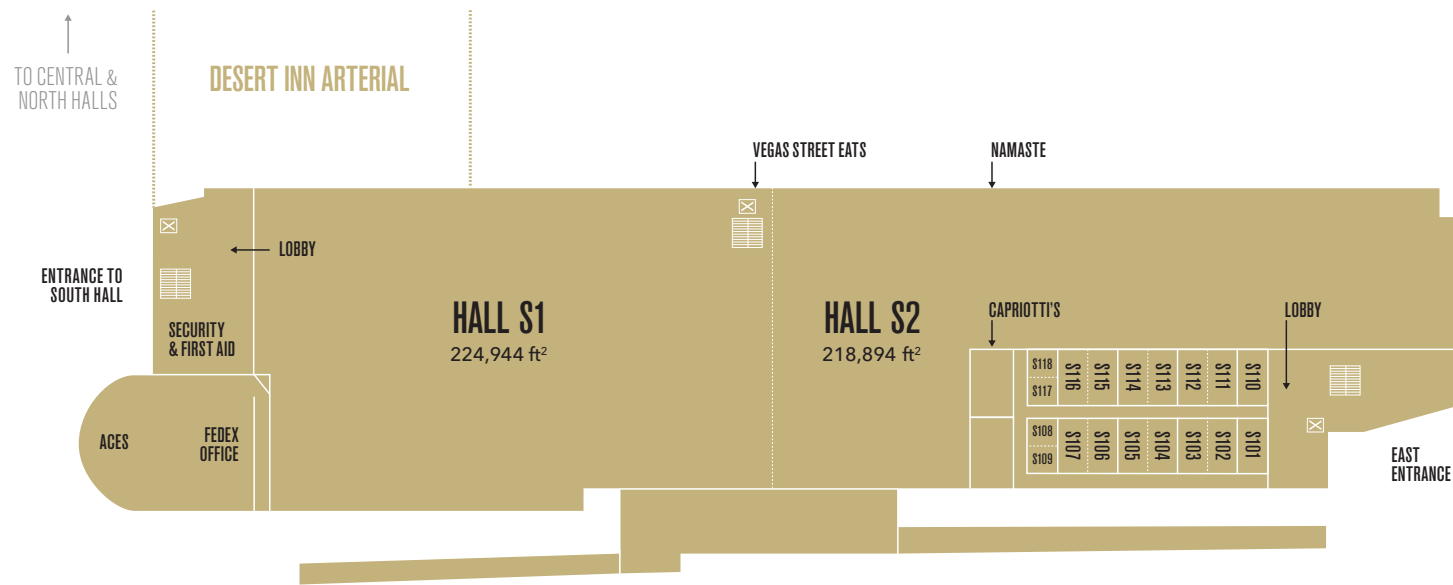

- ☒ = ELEVATOR
- ▣ = ESCALATOR

MEETING ROOMS | N252 - S118

MEETING ROOM	ROOM DIMENSION	SQUARE FEET	CEILING HEIGHT	DAILY RATES	THEATER CAPACITY	CLASSROOM CAPACITY	BANQUET CAPACITY
N252	58' x 47'	2,618	17'	\$900	232	128	130
N253	60'9" x 55'	3,218	17'	\$1,150	282	180	180
N254	59' x 47'	2,675	17'	\$950	234	136	130
N255	55' x 55'	2,934	17'	\$1,050	256	132	160
N256	62' x 47'	2,805	17'	\$1,000	253	144	170
N257	59' x 55'	3,180	17'	\$1,100	284	160	180
N258	63' x 47'	2,769	17'	\$950	254	136	150
N259	59' x 55'	3,152	17'	\$1,100	273	148	170
N260	65' x 47'	2,893	17'	\$1,000	245	128	170
N261	56' x 55'	2,976	17'	\$1,050	255	132	180
N262	61' x 47'	2,757	17'	\$950	256	128	170
N263	45' x 43'	1,945	17'	\$700	144	96	110
N263C	29' x 59'	1,605	17'	\$550	138	72	80
N264	53' x 47'	2,396	17'	\$850	214	104	130
DIAMOND 1	41' x 26'	598	9'	\$200	20	N/A	20
DIAMOND 2	27' x 26'	408	9'	\$150	20	N/A	20
DIAMOND 3	27' x 30'	443	10'	\$150	20	N/A	20
DIAMOND 4	27' x 30'	444	10'	\$150	20	N/A	20
S101	29' x 21'	608	13'	\$200	38	24	30
S102	29' x 44'	1,227	15'	\$450	78	40	60
S103	29' x 44'	1,227	15'	\$450	78	40	60
S104	29' x 44'	1,227	15'	\$450	78	40	60
S105	29' x 44'	1,229	15'	\$450	78	40	60
S106	29' x 44'	1,227	15'	\$450	78	40	60
S107	29' x 44'	1,227	15'	\$450	78	40	60
S108	31' x 21'	633	13'	\$200	35	24	40
S109	31' x 22'	618	13'	\$200	33	24	30
S110	29' x 44'	1,237	13'	\$450	78	40	60
S111	29' x 44'	1,225	15'	\$450	78	40	60
S112	29' x 44'	1,227	15'	\$450	78	40	60
S113	29' x 44'	1,224	15'	\$450	78	40	60
S114	29' x 44'	1,229	15'	\$450	78	40	60
S115	29' x 44'	1,226	15'	\$450	78	40	60
S116	29' x 44'	1,228	15'	\$450	78	40	60
S117	31' x 22'	636	13'	\$200	32	24	30
S118	31' x 21'	611	13'	\$200	30	16	30

Maps are not 100% true to scale, actual layout/size may vary.

SOUTH HALL | LEVEL 2

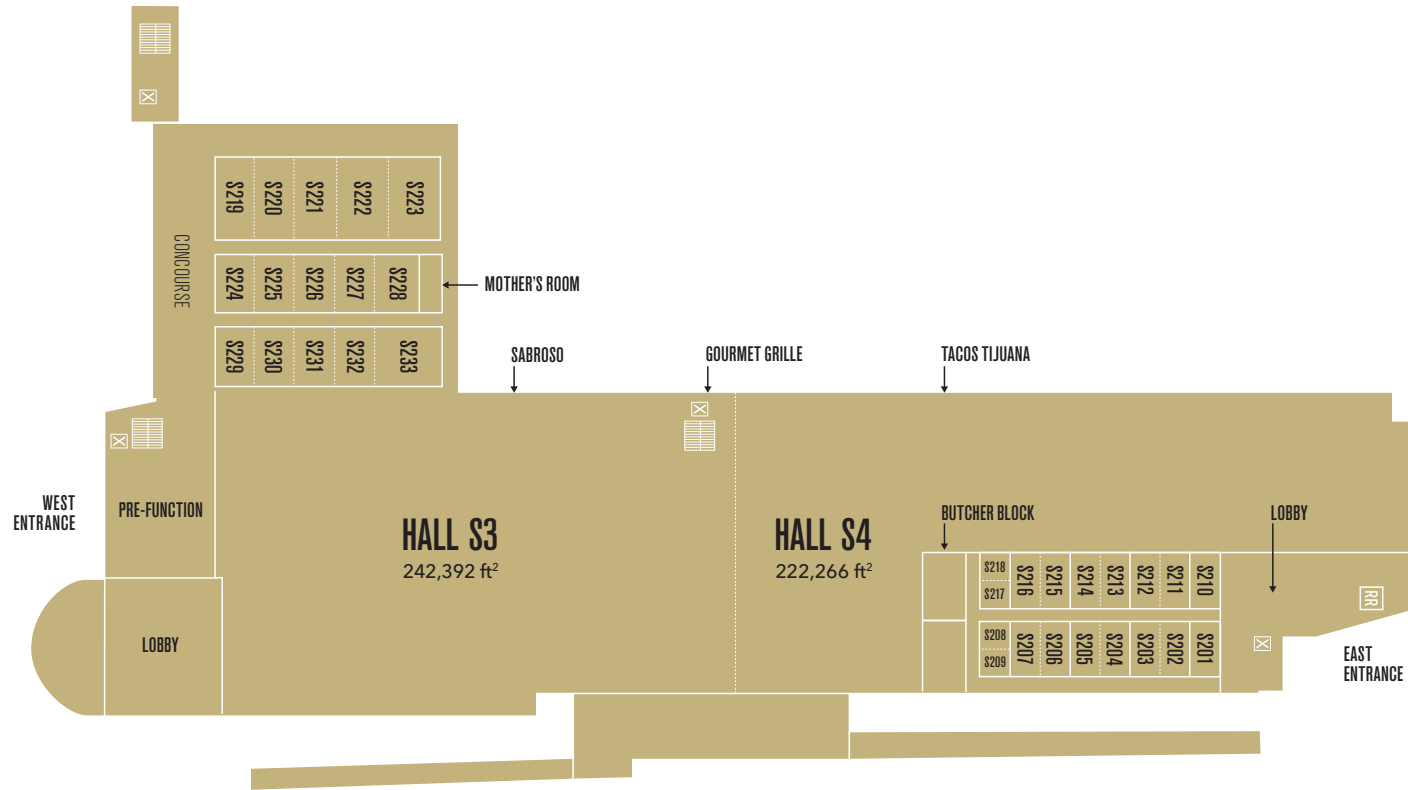

MEETING ROOMS | S201 - S233

MEETING ROOM	ROOM DIMENSION	SQUARE FEET	CEILING HEIGHT	DAILY RATES	THEATER CAPACITY	CLASSROOM CAPACITY	BANQUET CAPACITY
S201	34' x 21'	709	13'	\$250	45	28	40
S202	29' x 44'	1,223	15'	\$450	78	36	60
S203	29' x 44'	1,215	15'	\$450	78	36	60
S204	29' x 43'	1,221	15'	\$450	78	36	60
S205	29' x 43'	1,216	15'	\$450	78	36	60
S206	29' x 44'	1,221	15'	\$450	78	36	60
S207	29' x 44'	1,220	15'	\$450	78	36	60
S208	31' x 21'	637	13'	\$200	35	24	30
S209	31' x 22'	617	13'	\$200	37	16	20
S210	34' x 44'	1,354	13'	\$450	89	48	80
S211	29' x 44'	1,229	15'	\$450	78	36	60
S212	29' x 44'	1,230	15'	\$450	78	36	60
S213	29' x 44'	1,182	15'	\$400	78	32	60
S214	29' x 44'	1,181	15'	\$400	78	32	60
S215	29' x 44'	1,230	15'	\$450	78	36	60
S216	29' x 44'	1,233	15'	\$450	78	36	60
S217	31' x 21'	639	13'	\$200	35	16	30
S218	31' x 22'	622	13'	\$200	35	16	30
S219	45' x 95'	4,228	18'	\$1,500	380	224	220
S220	45' x 97'	4,194	18'	\$1,450	414	224	220
S221	44' x 97'	4,216	18'	\$1,500	353	208	220
S222	60' x 97'	5,599	18'	\$1,950	475	256	270
S223	61' x 97'	5,680	18'	\$2,000	520	336	280
S224	45' x 52'	2,296	18'	\$800	160	116	120
S225	45' x 52'	2,245	18'	\$800	160	112	110
S226	44' x 52'	2,240	18'	\$800	160	116	110
S227	45' x 52'	2,245	18'	\$800	160	116	110
S228	56' x 52'	2,781	18'	\$950	200	144	140
S229	45' x 66'	2,937	18'	\$1,050	260	144	170
S230	44' x 66'	2,868	18'	\$1,000	234	144	150
S231	45' x 66'	2,876	18'	\$1,000	234	144	150
S232	45' x 66'	2,882	18'	\$1,000	252	144	150
S233	76' x 66'	4,921	18'	\$1,700	468	240	290



WEST HALL | LEVELS 1 & 2

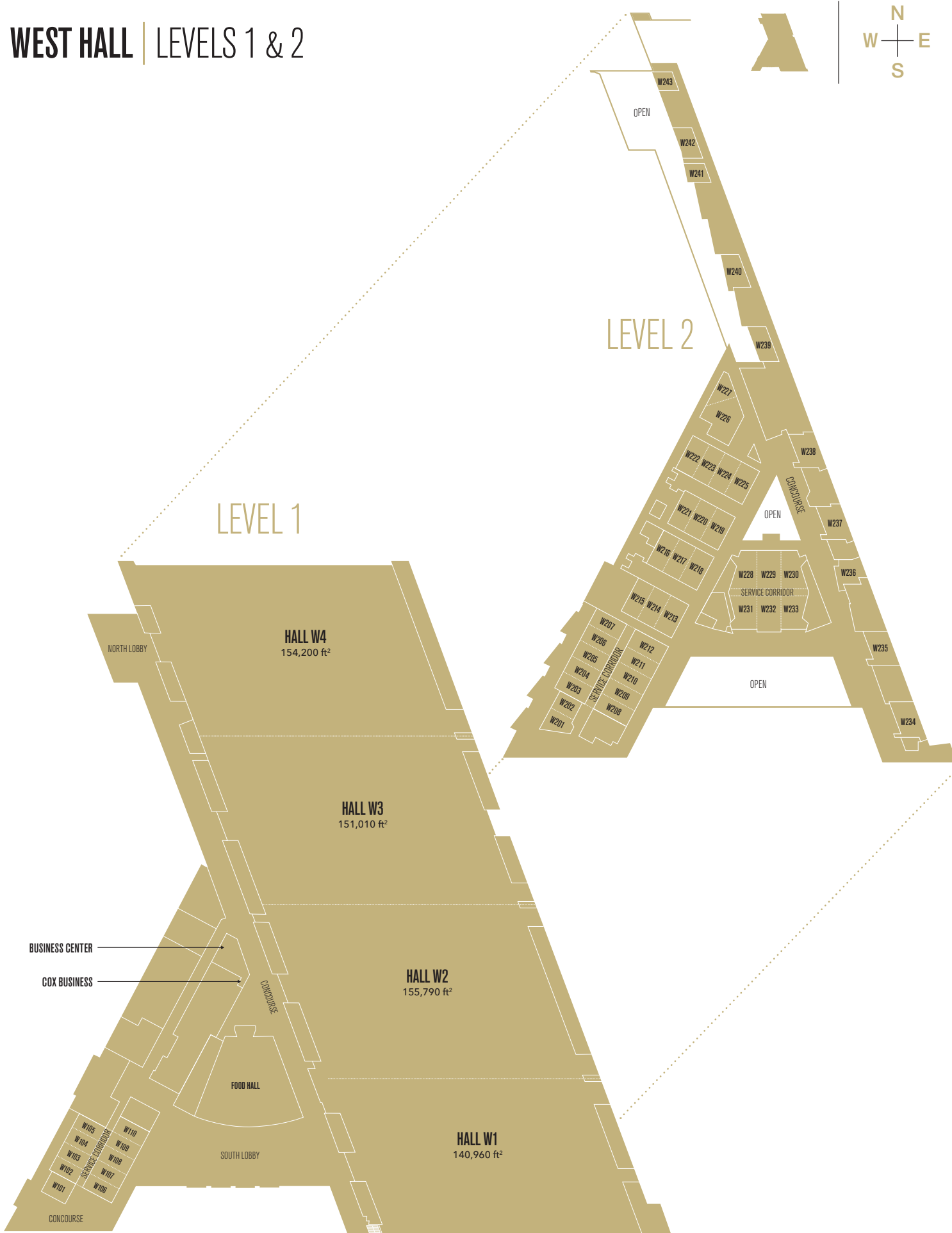

MEETING ROOMS | W101 – W218

MEETING ROOM	ROOM DIMENSION	SQUARE FEET	CEILING HEIGHT	DAILY RATES	THEATER CAPACITY	CLASSROOM CAPACITY	BANQUET CAPACITY
W101	51'x42'	1,847	21'	\$650	144	70	60
W102	52'x28'	1,458	21'	\$500	222	104	100
W103	52'x30'	1,492	21'	\$500	222	104	100
W104	52'x30'	1,497	21'	\$500	222	104	100
W105	52'x28'	1,460	21'	\$500	222	104	100
W102-105	--	5,907	21'	\$2,000	888	416	400
W106	58'x28'	1,642	21'	\$550	222	104	100
W107	58'x30'	1,685	21'	\$600	222	104	100
W108	58'x30'	1,685	21'	\$600	222	104	100
W109	58'x30'	1,685	21'	\$600	222	104	100
W110	60'x29'	1,713	21'	\$600	173	80	90
W106-110	--	8,410	21'	\$2,950	1061	496	490
W102-110	--	16,108	21'	\$4,950	1,949	912	890
W201	41'x32'	1,559	20'	\$550	162	92	70
W202	40'x33'	1,343	20'	\$450	162	92	70
W201-202	--	2,902	20'	\$1,000	324	184	140
W203	55'x29'	1,571	21'	\$550	226	110	102
W204	55'x30'	1,585	21'	\$550	226	110	102
W205	55'x30'	1,585	21'	\$550	226	110	102
W206	55'x30'	1,585	21'	\$550	226	110	102
W207	55'x28'	1,565	21'	\$550	226	110	102
W203-207	--	7,891	21'	\$2,750	1,130	550	510
W208	58'x29'	1,704	21'	\$600	226	110	102
W209	58'x30'	1,718	21'	\$600	226	110	102
W210	58'x30'	1,718	21'	\$600	226	110	102
W211	58'x30'	1,718	21'	\$600	226	110	102
W212	58'x28'	1,650	21'	\$600	226	110	102
W208-212	--	8,508	21'	\$3,000	1,130	550	510
W203-212	--	18,649	21'	\$5,750	2,260	1,100	1,020
W213	55'x31'	1,937	20'	\$700	200	106	83
W214	55'x29'	1,726	20'	\$600	200	106	83
W215	55'x29'	1,739	20'	\$600	200	106	83
W213-215	--	5,402	20'	\$1,900	600	318	249
W216	58'x30'	1,807	20'	\$650	200	106	83
W217	58'x29'	1,829	20'	\$650	200	106	83
W218	58'x28'	1,752	20'	\$600	200	106	83
W216-218	--	5,388	20'	\$1,900	600	318	249

Maps are not 100% true to scale, actual layout/size may vary.

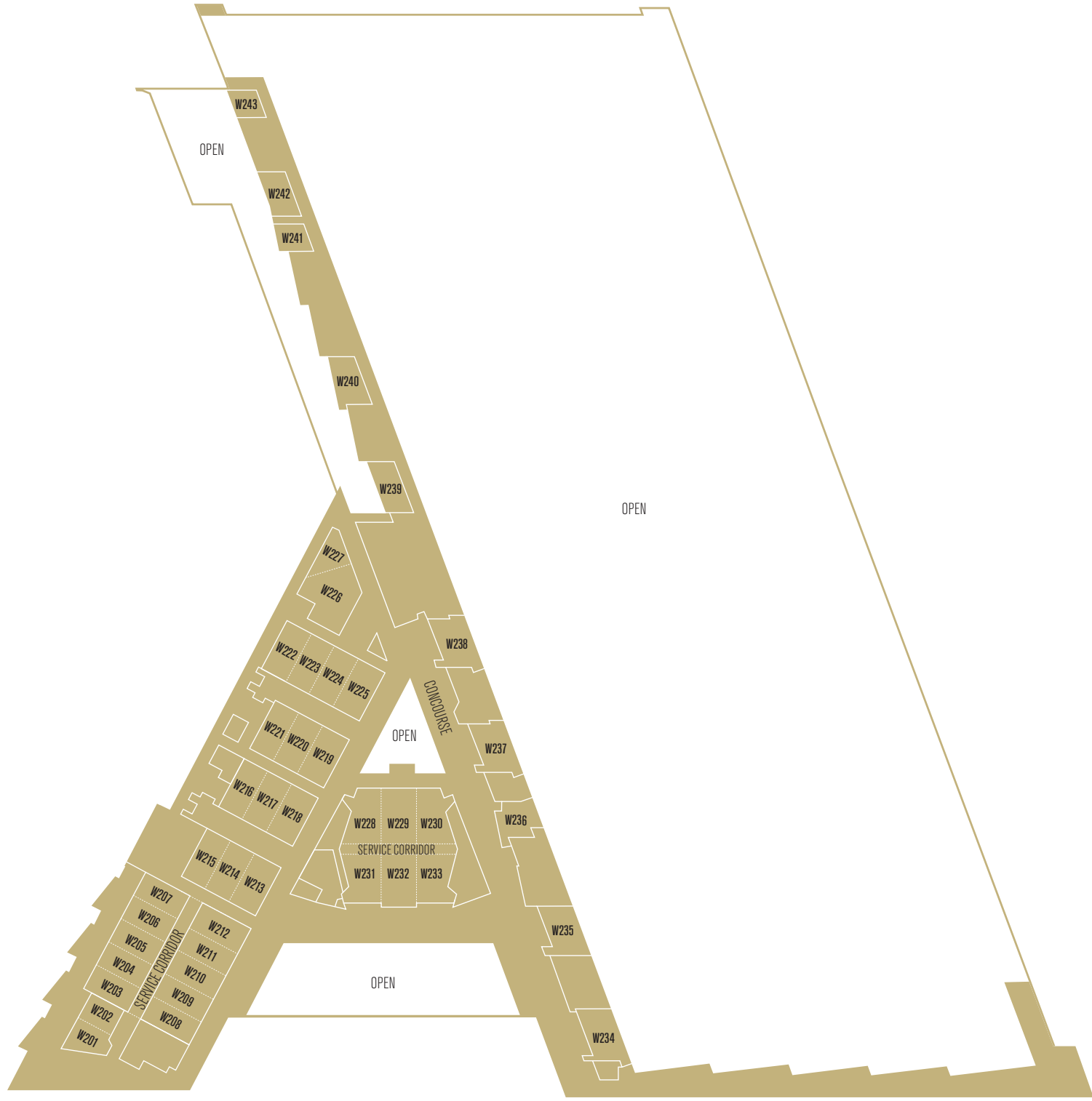

MEETING ROOMS | W219 – W243

MEETING ROOM	ROOM DIMENSION	SQUARE FEET	CEILING HEIGHT	DAILY RATES	THEATER CAPACITY	CLASSROOM CAPACITY	BANQUET CAPACITY
W219	54'x30'	1,903	20'	\$650	200	106	83
W220	54'x29'	1,726	20'	\$600	200	106	83
W221	54'x29'	1,724	20'	\$600	200	106	83
W219-221	--	5,353	20'	\$1,850	600	318	249
W222	55'x33'	1,955	20'	\$700	212	110	87
W223	55'x29'	1,722	20'	\$600	212	110	87
W224	55'x29'	1,736	20'	\$600	212	110	87
W225	55'x33'	1,912	20'	\$650	212	110	87
W222-225	--	7,325	20'	\$2,550	848	440	348
W226	83'x33'	2,672	20'	\$950	191	108	90
W227	65'x28'	1,817	20'	\$650	191	108	90
W226-227	--	4,489	20'	\$1,600	382	216	180
W228	62'x37'	2,385	21'	\$850	304	163	135
W229	62'x38'	2,275	21'	\$800	304	163	135
W230	62'x36'	2,284	21'	\$800	304	163	135
W228-230	--	6,944	21'	\$2,450	912	489	405
W231	53'x38'	2,228	21'	\$800	304	163	135
W232	59'x39'	2,296	21'	\$800	304	163	135
W233	53'x37'	2,120	21'	\$750	304	163	135
W231-233	--	6,644	21'	\$2,350	912	489	405
W228-233	--	15,245	21'	\$4,800	1,824	978	810
W234	56'x37'	2,273	11'	\$800	255	124	80
W235	56'x36'	2,180	11'	\$750	255	124	80
W236	45'x36'	1,657	11'	\$600	78	48	N/A
W237	55'x36'	2,197	11'	\$750	255	124	80
W238	57'x36'	2,245	11'	\$800	255	124	80
W239	55'x25'	1,369	11'	\$500	255	124	80
W240	54'x25'	1,452	11'	\$500	255	124	80
W241	34'x26'	906	11'	\$300	78	48	N/A
W242	51'x25'	1,236	11'	\$450	122	64	70
W243	31'x25'	770	11'	\$250	70	45	50

WEST HALL | LEVEL 3



MEETING ROOMS | W301 – W327

MEETING ROOM	ROOM DIMENSION	SQUARE FEET	CEILING HEIGHT	DAILY RATES	THEATER CAPACITY	CLASSROOM CAPACITY	BANQUET CAPACITY
W301	50'x20'	1,035	21'	\$350	78	56	N/A
W302	50'x20'	1,032	21'	\$350	78	56	N/A
W303	54'x27'	1,475	21'	\$500	297	110	98
W304	54'x30'	1,569	21'	\$550	297	110	98
W305	54'x30'	1,569	21'	\$550	297	110	98
W306	54'x28'	1,573	21'	\$550	297	110	98
W303-306	--	6,186	21'	\$2,150	1,188	440	392
W307	58'x27'	1,611	21'	\$550	297	110	98
W308	58'x30'	1,724	21'	\$600	297	110	98
W309	58'x30'	1,724	21'	\$600	297	110	98
W310	58'x28'	1,679	21'	\$600	297	110	98
W307-310	--	6,738	21'	\$2,350	1,188	440	392
W303-310	--	14,735	21'	\$4,500	2,376	880	784
W311	55'x31'	1,797	21'	\$650	200	106	83
W312	55'x29'	1,743	21'	\$600	200	106	83
W313	55'x28'	1,709	21'	\$600	200	106	83
W311-313	--	5,249	21'	\$1,850	600	318	249
W314	58'x28'	1,787	21'	\$650	200	106	83
W315	58'x29'	1,829	21'	\$650	200	106	83
W316	58'x31'	1,943	21'	\$700	200	106	83
W314-316	--	5,559	21'	\$2,000	600	318	249
W317	51'x31'	1,854	21'	\$650	200	106	83
W318	51'x29'	1,661	21'	\$600	200	106	83
W319	52'x28'	1,635	21'	\$550	200	106	83
W317-319	--	5,150	21'	\$1,800	600	318	249
W320	60'x28'	1,771	21'	\$600	180	80	80
W321	60'x28'	1,788	21'	\$650	180	80	80
W322	62'x35'	2,386	21'	\$850	304	163	138
W323	62'x38'	2,294	21'	\$800	304	163	138
W324	62'x35'	2,336	21'	\$800	304	163	138
W322-324	--	7,016	21'	\$2,450	912	489	414
W325	52'x36'	2,167	21'	\$750	304	163	138
W326	59'x39'	2,262	21'	\$800	304	163	138
W327	52'x36'	2,118	21'	\$750	304	163	138
W325-327	--	6,547	21'	\$2,300	912	489	414
W322-327	--	15,217	21'	\$4,750	1,824	978	828
TERRACE	--	14,447	--	--	--	--	--

Maps are not 100% true to scale, actual layout/size may vary.

FREIGHT & ROLL-UP DOORS | MAPS

CENTRAL & NORTH HALL | LEVEL 1

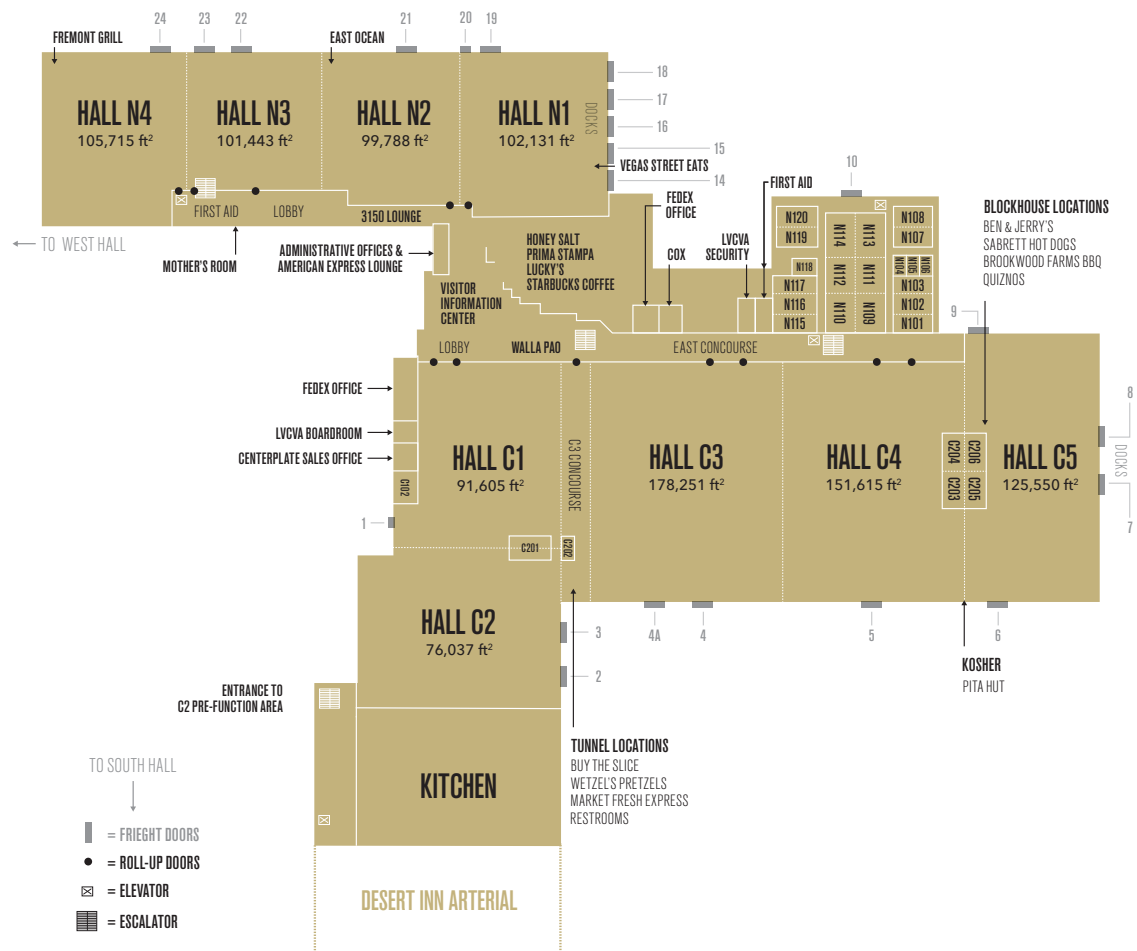

WEST HALL | LEVEL 1

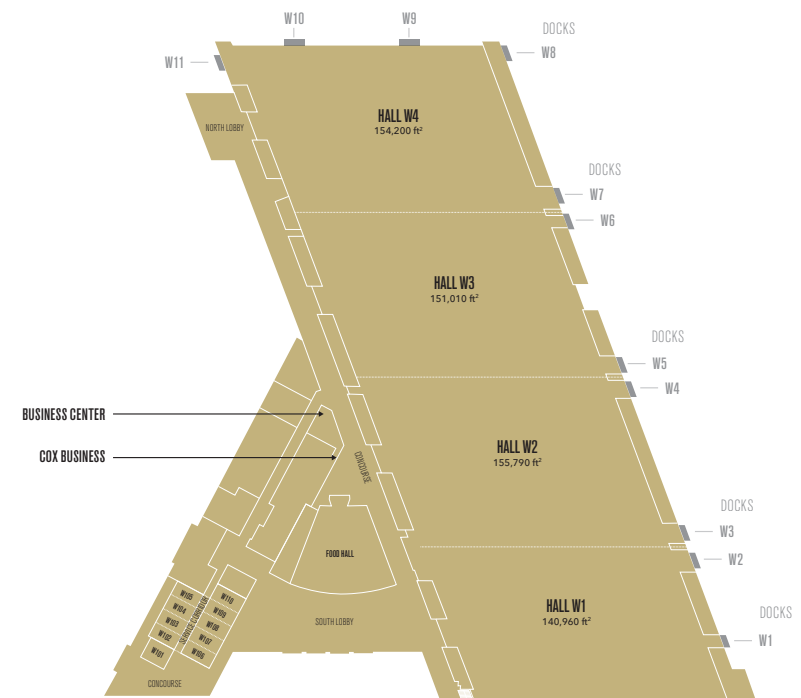

SOUTH HALL | LEVEL 1

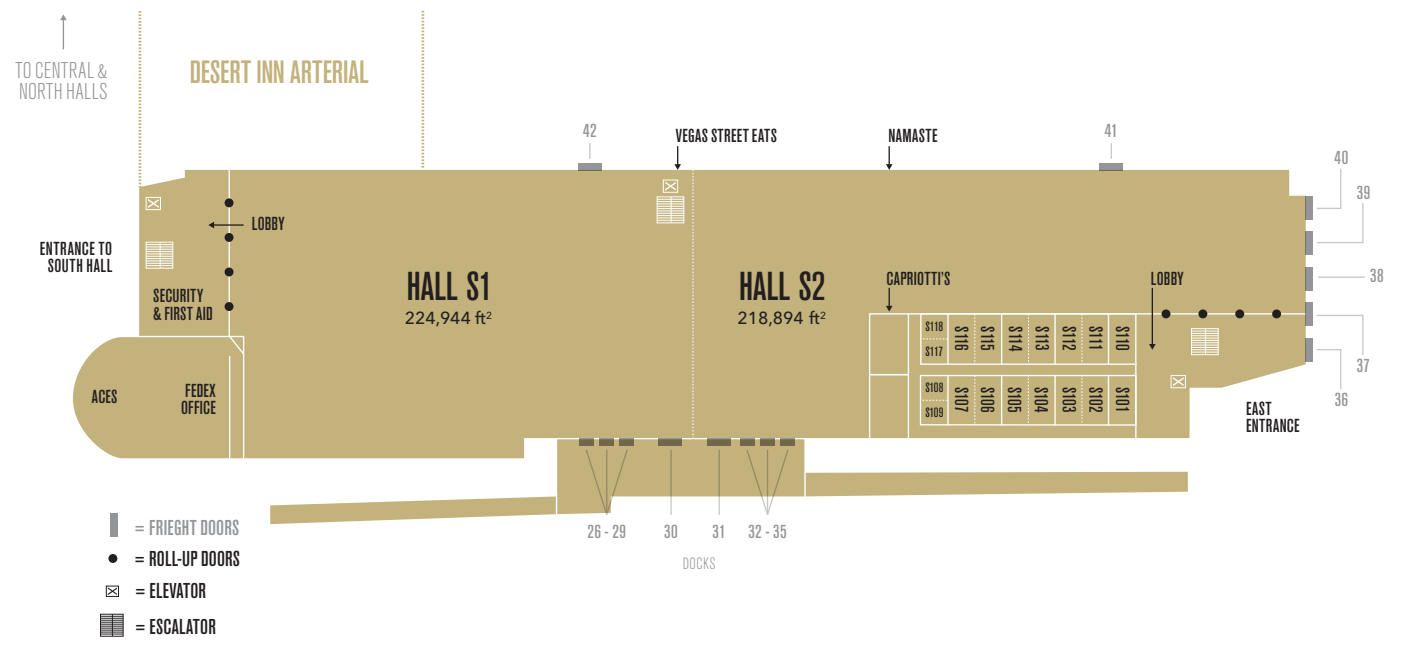

SOUTH HALL | LEVEL 2

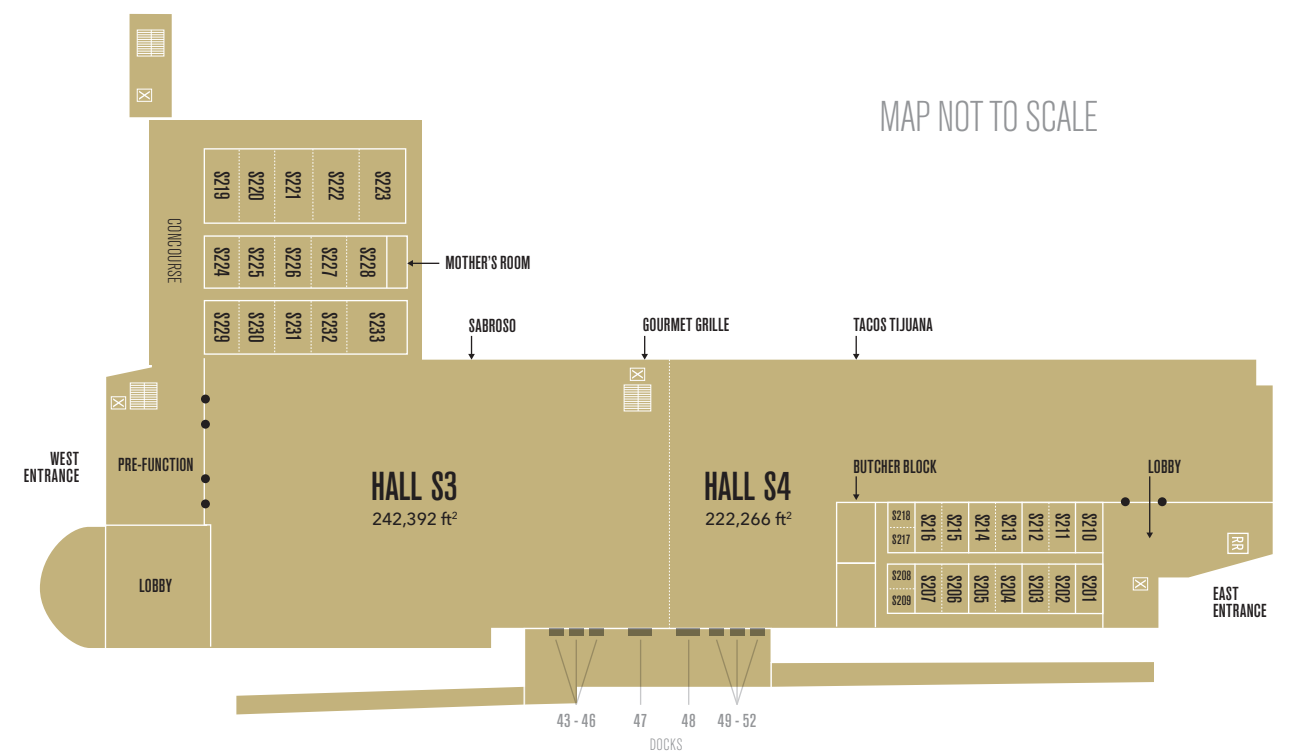



PARKING LOTS | INFORMATION FOR LEASABLE SPACE

PARKING LOT	LOT SQUARE FOOTAGE	NUMBER OF SPACES	PRICE PER LOT
SILVER LOT 1 A	104,332 ft ²	275	\$2,750
SILVER LOT 1 B	75,203 ft ²	221	\$2,210
SILVER LOT 1 SUBTOTAL	179,535 ft²	496	\$4,960
SILVER LOT 2 A	80,511 ft ²	204	\$2,040
SILVER LOT 2 B	44,041 ft ²	137	\$1,370
SILVER LOT 2 SUBTOTAL	124,552 ft²	341	\$3,410
SILVER LOT 3	91,361 ft ²	183	\$1,830
SILVER LOT 1-3 TOTAL	395,448 ft²	1,020	\$ 10,200
BRONZE LOT 1 A	108,404 ft ²	253	\$2,530
BRONZE LOT 1 B	113,997 ft ²	293	\$2,930
BRONZE LOT 1 SUBTOTAL	222,401 ft²	546	\$5,460
BRONZE LOT 2 A	110,107 ft ²	283	\$2,830
BRONZE LOT 2 B	67,183 ft ²	130	\$1,300
BRONZE LOT 2 SUBTOTAL	177,290 ft²	413	\$4,130
BRONZE LOT 3	129,820 ft ²	352	\$3,520
BRONZE 1-3 TOTAL	529,511 ft²	1311	\$13,110
PLATINUM LOT 1 A	95,045 ft ²	295	\$2,950
PLATINUM LOT 1 B	96,068 ft ²	205	\$2,050
PLATINUM LOT 1 SUBTOTAL	191,113 ft²	500	\$5,000
PLATINUM LOT 2 A	142,351 ft ²	333	\$3,330
PLATINUM LOT 2 B	58,880 ft ²	132	\$1,320
PLATINUM LOT 2 SUBTOTAL	201,231 ft²	465	\$4,650
PLATINUM LOT 3 A	163,487 ft ²	479	\$4,790
PLATINUM LOT 3 B	193,699 ft ²	388	\$3,880
PLATINUM LOT 3 SUBTOTAL	357,186 ft²	867	\$8,670
PLATINUM 1-3 TOTAL	749,530 ft²	1,832	\$18,320
DIAMOND LOT 1**	100,934 ft ²	276	\$2,760
DIAMOND LOT 2**	98,184 ft ²	280	\$2,800
DIAMOND 1-2 TOTAL	199,118 ft²	544	\$5,560
BLUE LOT 1	54,182 ft ²	140	\$1,400
BLUE LOT 2	42,836 ft ²	100	\$1,000
BLUE 1-2 TOTAL	97,018 ft²	245	\$2,450
ORANGE LOT 1	221,603 ft ²	332	\$3,320
ORANGE LOT 2	137,409 ft ²	250	\$2,500
ORANGE 1-2 TOTAL	226,267 ft²	582	\$5,820
RED LOT**	4,664 ft ²	--	--
WHITE LOT	87,940 ft ²	117	\$1,170
PARKING LOTS TOTAL	2,105,373 ft²	5,146	\$51,460

* When lot is leased in it's entirety, additional space is available.

*Silver Lot - Additional spce: 19,396 ft², 7 parking spaces | *Bronze Lot - Additional spce: 55,917 ft²

** Currently under construction

Lots are all subject to change due to current construction.

CONVENTION CENTER SERVICES & POLICIES

The Las Vegas Convention and Visitors Authority can help you plan the perfect gathering, from obtaining room blocks to facility recommendations. For additional information about lodging, transportation, attractions, shows and events, or to view Las Vegas maps, visit VegasMeansBusiness.com.

EXHIBIT HALLS

Minimum rate versus \$.35 per net square foot, whichever is greater, per individual hall, per show day when used for commercial exhibits. Total number of move in/move out days is equal to one times the number of show days at no charge. Additional move in/out days are priced at 50 percent of the charged rental rate of hall. One-half normal illumination will be allowed for move in and move out days. Additional lighting, heating and air conditioning requested by the Lessee will be assessed a charge based on actual usage during move in/move out.

MEETING ROOMS

Subject to availability meeting rooms will be assigned at the time exhibit space is tentatively held. Meeting room charges are based on 10 complimentary meeting rooms per 100,000 sq. feet of paid exhibition space. Additional meeting rooms are subject to availability at published rates. Meeting rooms used for exhibitions or subleased will be subject to additional charges. One-time setup per day includes custodial (except when used for offices or exhibit space), lights, heat, air and sound service. Changeovers and revised room set-ups will be charged a daily room rate. Refer to Exhibit A of lease for all other charges.

LOBBIES AND CONCOURSE

Lobbies and foyer areas are public domain areas and are to be used for ingress/egress. Leased commercial booths or manned publication booths may be permitted.



Central Hall



CENTERPLATE 702-943-6779

CenterplateLasVegas@centerplate.com

As the exclusive hospitality partner to the Las Vegas Convention Center, Centerplate is proud to offer full-service catering, pop-up and fixed retail dining, themed lounges, cafés and restaurants to meet the needs of our planners, exhibitors and guests. Our dedicated event professionals are committed to making the time you spend with us more enjoyable and more valuable. Please contact us about your next event.

SPONSORSHIP AND BRAND ACTIVATION

Want to go beyond the expected? How about a branded restaurant, right on the show floor? Or a sponsored program to add impressions and maximize exposure? We help you become part of the experience with marketing and sponsorship opportunities that extend beyond the booth to engage guests for a lasting connection. Give your Centerplate sales team a call to explore the possibilities.

RECEPTIONS, BANQUETS & BEYOND

Share your good taste with the world! This is your moment to make an impression, and our world-class culinary team and service professionals are here to help you shine. Craft a memorable event, with delicious, fun and inviting service and menus. Our catering and event managers specialize in getting it just right. Since it's Las Vegas, that means a wealth of possibilities: modern culinary, elegant banquets, fun cocktail receptions – for breakfast, lunch, dinner or anything in between. Contact us today for a portfolio of events and options.

EXHIBITOR HOSPITALITY

Centerplate can help you do more on the floor! Make your brand a destination with our exhibitor services designed to perk up your meetings or drive traffic to your booth.

- Need an in-booth café and espresso setup to capture attention and keep your clients fueled?
- How about catering or boxed meals to make sure that your event team isn't going hungry?

From engaging after-hours receptions to easy ordering of delicious meals for clients and staff, the Centerplate team is dedicated to Making It Better To Be There®. Contact our exhibitor sales team at exhibitorcateringlvcc@centerplate.com or order online: lvcaexpresscatering.ezplanit.com.

RESTAURANTS, CAFÉS AND RETAIL DINING

Conveniently located throughout the center in the exhibit halls, as well as two designated eat-in markets, Centerplate's dining options are casual and accessible with a tantalizing array of local and global flavors.

HIGHLIGHTS INCLUDE:

HoneySalt – Fresh and innovative farm-to-table inspired from the award-winning local restaurant by restaurateur Elizabeth Blau and Chef Kim Canteenwalla.

Walla Pao – Asian-inspired kitchen featuring cucumber wakame salad, Asian slaw, hand-rolled sushi rolls and authentic specialties.

Starbucks – Favorite stop for coffee, espresso, tea and bakery goods.

Lucky's Restaurant (Level 1, located off the Grand Lobby) and **Aces Restaurant** (Level 1, located in the South Hall Lobby) each feature Bachi Burger, Lindo Michoacan, Atomic Pizza, salads, sandwiches, beverages, and a variety of grab-and-go snacks.

Additional options include Kosher foods, fresh salads, Mexican, pizza, barbecue, and more.



COX BUSINESS – ADVANCED CONVENTION SERVICES

Toll Free 855-519-2624 | FAX 833-467-1219
lvcc.orders@cox.com | TradeShows.coxhn.net

Cox Business is the exclusive full-service provider for all data, voice and cable TV services at the Las Vegas Convention Center (LVCC).

DIGITAL ADVERTISING

Reach convention attendees through advertising on the 7 location, 14 display digital signage network throughout the LVCC. These strategically placed monitors range in size from a 55" monitor to our two 40 foot seamless LED screens in the grand lobby.

INTERNET AND WIFI SERVICES

Cox Business has a full array of internet services available. We can customize a solution that fits all your specific needs for the show. From shared and dedicated high-speed internet access (up to 10 Gbps) to special circuit needs, Cox Business will deliver a seamless network solution. Our services include best-of-class switches, hubs and cabling.

VOICE SERVICES

Stay connected throughout the show with the full suite of voice solutions from Cox Business. Process your orders directly on the spot with our single line service or leverage our Polycom conference phones to work hands free.

VIDEO SERVICES

Complement your event with dynamic cable television service that includes a full HD line up. Cox Business offers a variety of channels, from local broadcast, news, sports, weather and specialized programming, to keep your guests entertained.



FEDEx OFFICE 702-733-2898

FedEx Office is the leader in document management, production and fulfillment services to the Convention and Hospitality industry. With the broadest range of digital document production services and solution centers, FedEx Office has applied this expertise and understanding of this unique market at multiple convention properties around the world. Their experience and superior levels of quality customer service continues to set the pace.



AMERICAN EXPRESS LOUNGE

Each day, American Express makes it easier, safer and more rewarding for consumers and businesses to purchase the things they need and for merchants to sell their goods and services. An engine of commerce, American Express provides innovative payment, travel and expense management solutions for individuals and businesses of all sizes.

The American Express Lounge provides American Express customers with a productive retreat while attending events at the Las Vegas Convention Center. Whether you need somewhere quiet to meet, a break from the trade show floor, Wi-Fi, or coffee and snacks, American Express is there to support you. You can find the American Express Lounge after you walk through the Central Hall main entrance.

For more information, please visit AmericanExpress.com/conventioncenterlounges





A NEW ERA IN BUSINESS

LAS VEGAS CONVENTION AND VISITORS AUTHORITY

3150 Paradise Rd., Las Vegas, NV 89109-9096

T: 702-892-0711 | F: 702-892-2824

Learn more at VegasMeansBusiness.com

